



## COLLIER DE SERRAGE À POINÇON PUNCH – TYPE BAND CLAMP

### RENSEIGNEMENTS SUR LE PRODUIT / PRODUCT INFORMATION

#### Utilisation / Application

Pour les applications générales à basse pression. Mesurer le diamètre extérieur du tuyau et sélectionner le collier de diamètre supérieur. S'installe avec l'outil P1-HD  
 For general low pressure service. Measure the outside diameter of the hose and then select the next larger size clamp. Requires the P1-HD tool for installation.

#### Matériaux / Materials

Acier galvanisé et Acier inoxydable  
 Galvanized Steel and Stainless Steel

DIMENSION	ACIER GALVANISÉ	ACIER INOXYDABLE
SIZE	GALVANIZED STEEL	STAINLESS STEEL
1	52.CP04 (S)	52.CPS04 (S)
1-1/4	52.CP05 (S)	52.CPS05 (S)
1-1/2	52.CP06 (S)	52.CPS06 (S)
1-3/4	52.CP07 (S)	52.CPS07 (S)
2	52.CP08 (S)	52.CPS08 (S)
2-1/4	52.CP09 (S)	52.CPS09 (S)
2-1/2	52.CP10 (S)	52.CPS10 (S)
2-3/4	52.CP11 (S)	52.CPS11 (S)
3	52.CP12 (S)	52.CPS12 (S)
3-1/2	52.CP14 (S)	52.CPS14 (S)
4	52.CP16 (S)	52.CPS16 (S)
4-1/2	52.CP18 (S)	52.CPS18 (S)
5	52.CP20 (S)	52.CPS20 (S)
6	52.CP24 (S)	52.CPS24 (S)
6-1/2	52.CP26 (S)	52.CPS26 (S)
7	52.CP28 (S)	52.CPS28 (S)
8	52.CP32 (S)	52.CPS32 (S)



**OUTIL P1 - HD**  
**P1 - HD TOOL**  
**N° 50. P1 - HD**

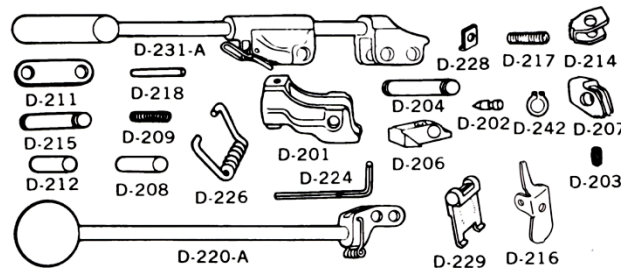

**PIÈCES DE REMPLACEMENT POUR OUTIL P1 - HD**  
**REPLACEMENT PARTS FOR P1 - HD TOOL**

NUMÉRO DE PIÈCE	DESCRIPTION
PART NUMBER	DESCRIPTION
50.T201	Punch Head
50.T202	Punch
50.T203	Set Screw
50.T204	Punch Head Pin (1-7/8")
50.T206	Pusher Nose
50.T207	Holding Dog
50.T208	Pusher Nose Pin (15/16"long)
50.T209	Holding Dog Spring (long)
50.T211	Puller Link
50.T212	Puller Link Pin (5/8"long)
50.T214	Pulling Dog
50.T215	Pulling Dog Pin (11/32")

NUMÉRO DE PIÈCE	DESCRIPTION
PART NUMBER	DESCRIPTION
50.T216	Release Lever
50.T217	Pulling Dog Spring (short)
50.T218	Release Lever Pin
50.T220A	Ball Handle Assembly
50.T224	Wrench
50.T226	Limit Ring
50.T228	Formed Washer
50.T229	3/8" Clamp Adapter
50.T231A	Pusher-Puller Assembly (for P-1 Tool only)
50.T242	Retaining Rings